

Unit Assembly Instructions:

Use a 1/4" seam allowance for all piecing; fabric right sides together. *Read all instructions before beginning.*

"Sewper" Way to Make Half Square Triangles, Finished Size 2" Square, Unfinished Size 2 1/2"

This is a fast and simple way to make **Half Square Triangles**. Follow steps 1 through 4.

Cut one 4 1/8" square of each of the fabrics called-out for the **Half Square Triangles**.

1. With right sides together, sew 1/4" seam along all four sides of the square. *Spray starch and press flat before cutting.*

2. Rotary cut twice diagonally.

3. Press the seam toward the darker fabric. *Because this is cut on the bias, do not use steam in your iron.*

4. Align 45° line of ruler along the seam and **Trim to 2 1/2" Square**. Snip off the dog ears.

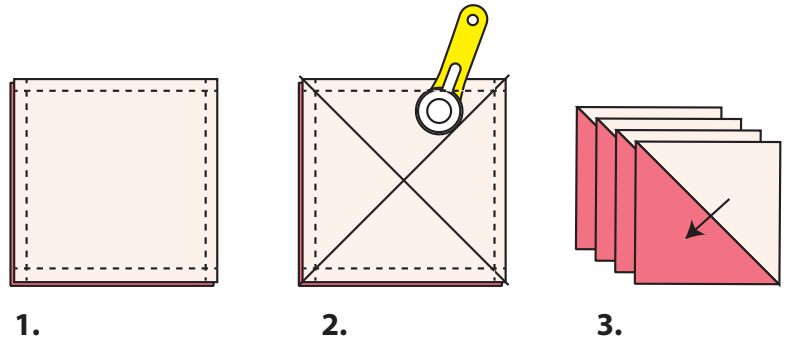

Flying Geese Units, Finished Size 4" x 2", Unfinished Size 2 1/2" x 4 1/2"

Follow these steps for a quick set of four **Flying Geese**.

Cut four squares 2 7/8" from the fabric called-out for the smaller triangles or "wings."

Cut one square 5 1/4" from the fabric called-out for the larger triangle or "body."

1. Take four 2 7/8" squares and draw a diagonal line on the wrong side of the fabric.

2. Take one 5 1/4" square and position two of the 2 7/8" squares in opposite corners, right sides together as indicated in the diagram. Pin in place and sew a 1/4" seam on both sides of the drawn line.

3. Cut on the drawn line.

4. Press the triangle points as indicated by the arrows on both units.

5. Position another 2 7/8" square as indicated. Pin and sew 1/4" seam on both sides of the drawn line. Repeat for the other unit.

6. Cut on the drawn line. Press seams as the arrows indicate. Trim the dog ears and *presto*, four **Flying Geese**. **Flying Geese** should measure 2 1/2" x 4 1/2".

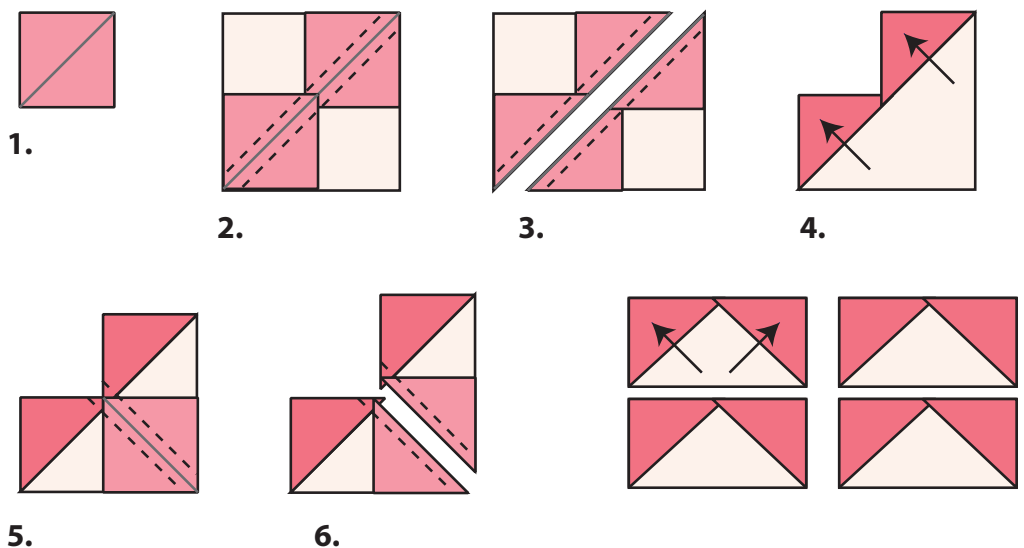



Month 1 - Robbing Peter to Pay Paul Blocks

Upper Left and Lower Right Stars - 12" Finished Size, 12 1/2" Unfinished Size

HST means Half Square Triangle and **FG** means Flying Geese

Cut for Block A

0531-1042  Three 4 1/8" squares for **HST**
One 5 1/4" square for **FG**
Four 2 1/2" squares for corners

0526-1026  One 4 1/2" center square

0527-1044  Four 2 1/2" x 4 1/2" rectangles

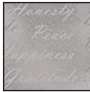
0528-1070  One 4 1/8" square for **HST**

0528-1031  Two 4 1/8" squares for **HST**
Four 2 7/8" squares for **FG**

Cut for Block B

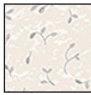
0531-1042  Two 4 1/8" squares for **HST**
One 5 1/4" square for **FG**
Four 2 1/2" squares for corners

0526-1026  One 4 1/2" center square

0527-1024  Four 2 1/2" x 4 1/2" rectangles

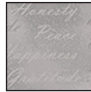
0528-1070  Three 4 1/8" squares **HST**

0528-1043  One 4 1/8" square **HST**

0528-1031  Four 2 7/8" squares for **FG**

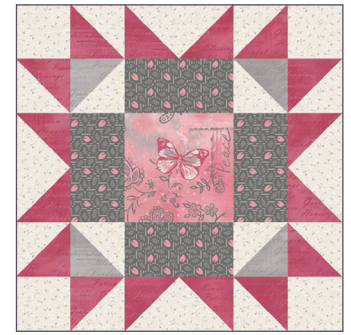

Block A



Block B

1. Sew the **Half Square Triangles** and the **Flying Geese** according to sewing instructions on page 3.

For Block A: Make four **Flying Geese (FG)** with the Cream 5 1/4" square and four 2 7/8" Ruby squares. Make a total of eight Ruby and Cream **Half Square Triangles (HST)**. Make a total of four Gray and Cream **HST**.

For Block B: Make four **FG** with the Cream 5 1/4" square and four 2 7/8" Ruby squares. Make a total of eight Light Gray and Cream **HST**. Make a total of four Dark Gray and Light Gray **HST**.

2. Lay out the pieces according to the diagram below for **Block A**.

3. Sew the pieces into rows. Press the seams in alternating directions, as shown below.

4. Align the seams, pin, and sew the rows together. Press seams toward the bottom of the block. Block should measure 12 1/2". Repeat for **Block B**, using the diagram above as a color placement reference.

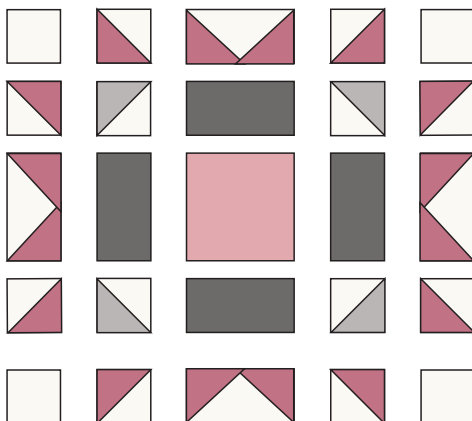

2.

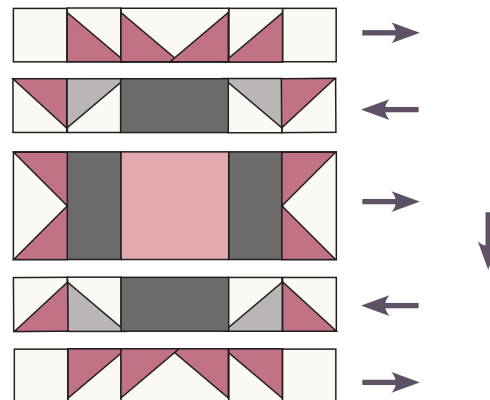

3.