

# Month 5 Pieced Border Blocks

Corner Square Triangle Blocks and Irish Chain Blocks - 4" Finished Size  
*WOF means Width of Fabric*

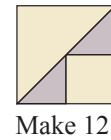

Corner Square Triangle Blocks

## Cutting Instructions



Ten 4 7/8" squares, cut once on the diagonal for 20 triangles  
 Thirty-six 2 1/2" squares for Corner Square Triangles (20) and Irish Chain (16)  
 Two 1 1/2" x **WOF** strips for Irish Chain



Twelve 2 7/8" squares, cut once on the diagonal for 24 triangles



Eight 2 7/8" squares, cut once on the diagonal for 16 triangles



Two 1 1/2" x **WOF** strips for Irish Chain



Irish Chain Block

## Irish Chain Block

1. Refer to Month 3, page 5 for sewing directions. Make 16 Four Patch units in order to complete 8 Irish Chain Blocks.

## Corner Square Triangle Blocks

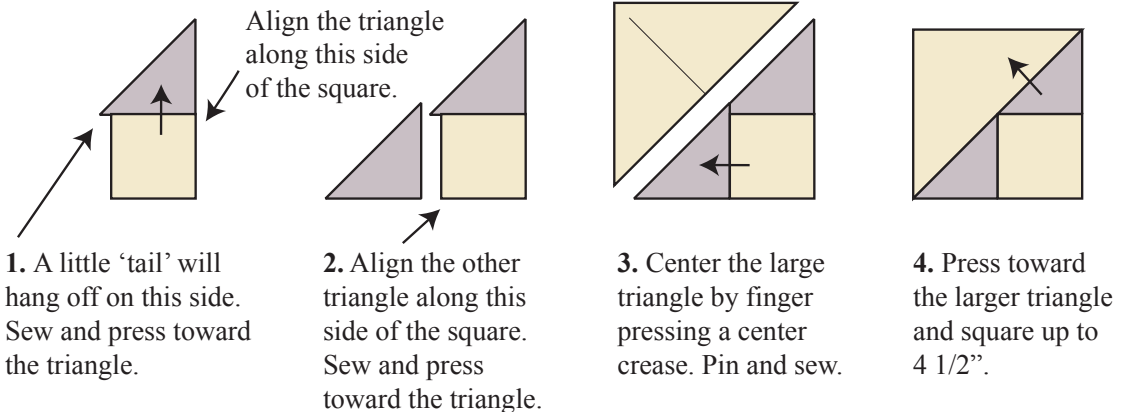

5. Make 12 Corner Square Triangle Blocks using the purple fabric and 8 Corner Square Triangle Blocks with green fabric. Set aside four of the purple blocks for the corners.

6. Arrange the blocks in two layouts, A and B.

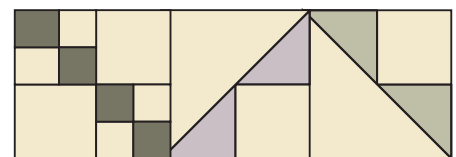
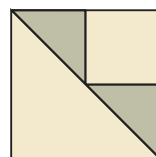
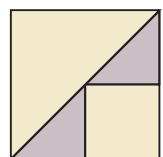
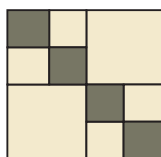

7. Sew the blocks together and press the seams in one direction. Make 4 of each layout. Should measure 12 1/2" x 4 1/2".

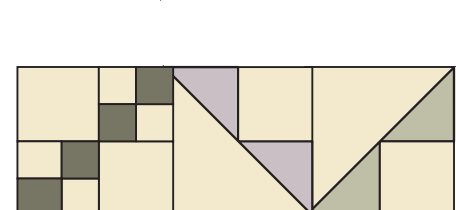
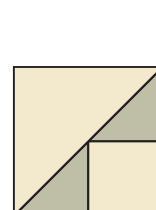
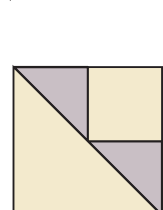
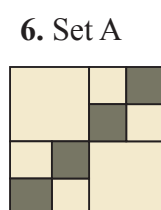

6. Set B

7. Make 4 of each A and B sets